

**CERTIFIED RECORD OF LAND CORNER MONUMENTATION**

**History of original corner establishment:**

Not previously established

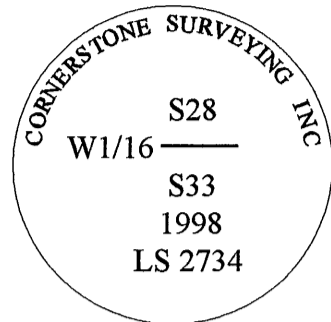

W1/16 Sec.28 T9S, R32E

**Description of corner evidence found:**

Not previously established

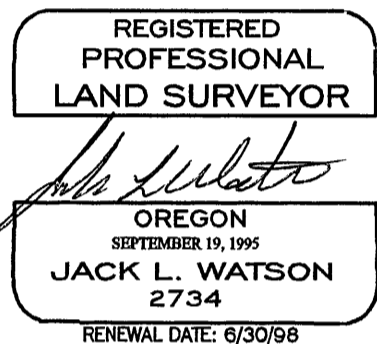

See Grant County Survey No. 1477

**Description of monument and accessories set at corner location:**

At the position determined by survey, I set a 5/8"x30" iron pin with attached 1 1/2" aluminum cap, the cap is stamped as shown in the diagram.

From which I set a new reference monument:

A 5/8"x30" iron pin bears N17°E, 25.83 feet, with attached red plastic cap marked CORNERSTONE SURVEYING INC.

From which I scribe a new bearing tree:

A 21" P.Pine bears S12°W, 58.80 feet, marked W1/16S33BT.

I used magnetic compass, with 20° east variation, to center of BT and steel tape measuring to a 50d nail driven in the side center at the root crown of the BT. I used a magnetic compass, with 20° east variation and steel tape to tie reference. Built mound of stone around monument.

Date: April 27, 1998

Office of SURVEYOR County of GRANT  
State of OREGON, I hereby certify that the within instrument was filed in this office  
for record on the 20 day of MAY, 1998.  
Robert D. Baggett by \_\_\_\_\_  
(COUNTY OFFICIAL) (DEPUTY)